

**EXISTING SITE**



# PROPOSED BUILDING FORM



Building	Number of Storeys
Building A	6 (+ lower ground floor)
Building B	3 - 4
Building C	4
Building D	5

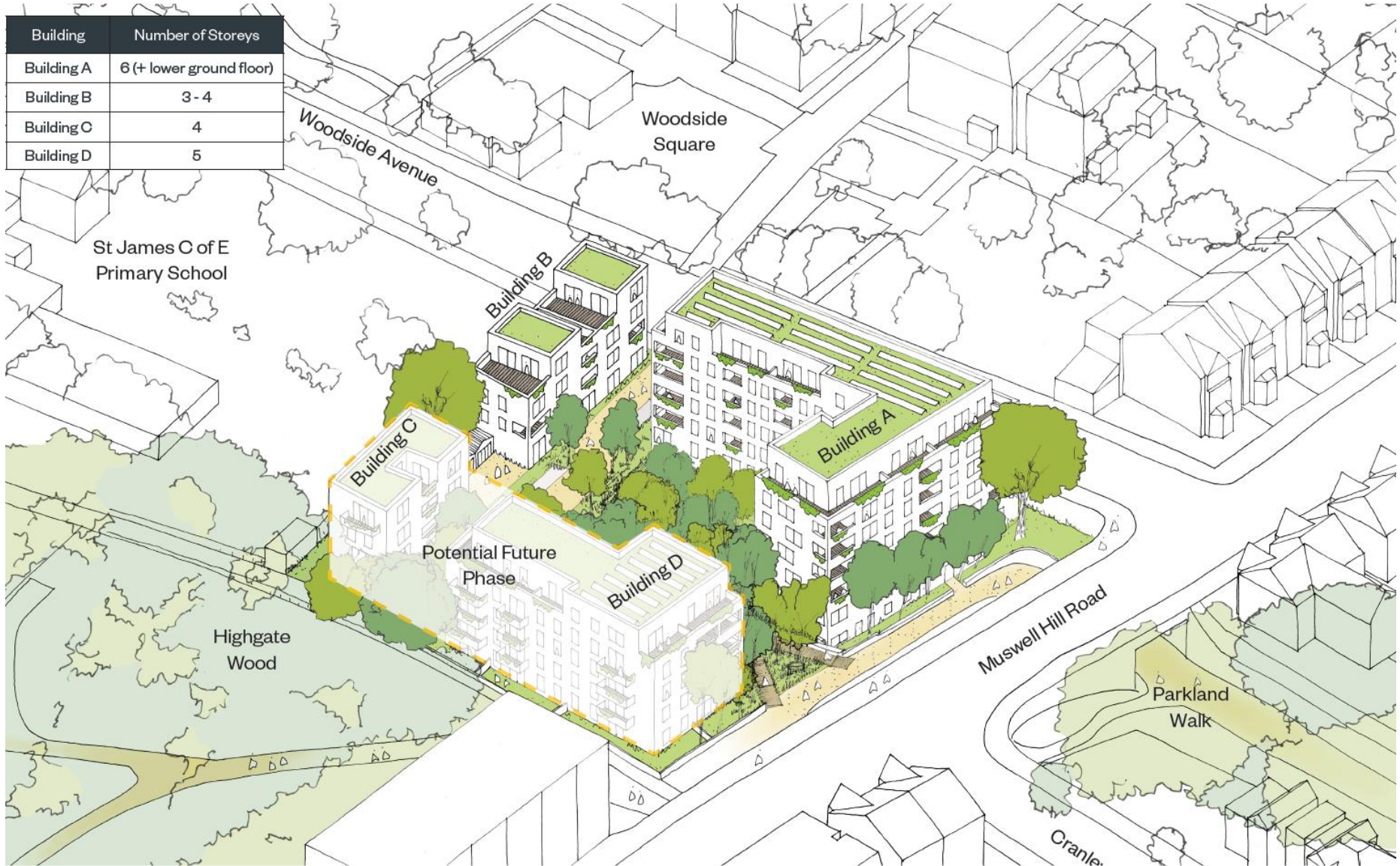

## SKETCH STREET VIEW



Muswell Hill Road looking south



### Building A

Type of Dwelling	Number of Dwellings
1B2P Flat	13
2B3P Flat	1
2B4P Flat	15
3B5P Flat	3
3B5P Maisonette	4
<b>Total</b>	<b>36</b>

### Building B

Type of Dwelling	Number of Dwellings
2B4P Flat	2
2B3P Flat	2
3B5P Maisonette	2
<b>Total</b>	<b>6</b>